

PLANT SPECIES LIST:

Trees:

- Acer campestre 'Streetwise'
- Aesculus hippocastanum
- Alnus glutinosa
- Alnus x spaethii
- Amelanchier lamarckii
- Amelanchier lamarckii 'Robin Hill'
- Betula 'Edinburgh'
- Betula pendula
- Betula pubescens
- Crataegus laevigata 'Paul's Scarlet'
- Fagus sylvatica
- Pyrus calleryana 'Chanticleer'
- Quercus robur
- Quercus rubra
- Sorbus aucuparia
- Tilia cordata 'Greenspire'

Plant species within bioretention areas:

- Ajuga reptans 'Caitlin's Giant'
- Berberis thunbergii var. atropurpurea 'Nana'
- Bergenia cordifolia
- Calamagrostis x acutiflora 'Overdam'
- Carex divulsa
- Carex morrowii 'Ice Dance'
- Deschampsia caespitosa 'Goldtau'
- Fritillaria meleagris
- Fritillaria meleagris 'Alba'
- Geranium oxonianum 'Wargrave Pink'
- Sanguisorba officinalis 'Red Thunder'
- Stachys byzantina 'Silver Carpet'
- Verbena bonariensis 'Lollipop'

Plant species within on-plot planting:

- Armeria maritima
- Aucuba japonica 'Rozannie'
- Buxus sempervirens 'Suffruticosa'
- Deschampsia caespitosa 'Goldtau'
- Dryopteris wallichiana
- Echinops ritro 'Veitch's Blue'
- Erica carnea 'Foxhollow'
- Erica carnea 'Memory'
- Erica carnea 'Springwood White'
- Erigeron karvinskianus 'Profusion'
- Euonymus 'Jean Hugues'
- Euonymus 'Emerald Gaiety'
- Fatsia japonica
- Festuca glauca 'Elijah Blue'
- Geranium oxonianum 'Wargrave Pink'
- Geranium phaeum
- Hebe rakaiensis 'Golden Dome'
- Helenium 'Rubinzweg'
- Hylotelephium spectabile 'Brilliant'
- Hypericum 'Hidcote'
- Ilex crenata 'Luxus'
- Liriope muscari
- Liriope muscari 'Kindi Pink'
- Liriope muscari 'Monroe White'
- Mahonia aquifolium 'Apollo'
- Miscanthus sinensis 'Little Kitten'
- Molinia caerulea
- Polystichum setiferum
- Rudbeckia fulgida 'Goldstrum'
- Salvia nemorosa 'Caradonna'
- Sarcococca hookeriana var. digyna
- Sesleria autumnalis
- Skimmia 'Rubella'
- Viburnum tinus 'Eve Price'

Plant species in public open spaces:

- Cornus sanguinea 'Midwinter Fire'
- Crocus tommasinianus
- Deschampsia caespitosa 'Goldtau'
- Erica carnea 'Memory'
- Erica carnea 'Springwood White'
- Fagus sylvatica
- Hebe rakaiensis 'Golden Dome'
- Hebe pinguifolia 'Pagei'
- Molinia caerulea
- Narcissus obvallaris
- Polystichum setiferum
- Verbena bonariensis
- Viburnum opulus 'Compactum'

Native hedgerows:

- Corylus avellana
- Crataegus monogyna
- Ilex aquifolium
- Prunus spinosa
- Rosa canina
- Sorbus aucuparia
- Viburnum lantana

NOTES:

- Impact absorbing surface such as rubber grass reinforcement mats in line with BS 1177 to be installed where required around play equipment.

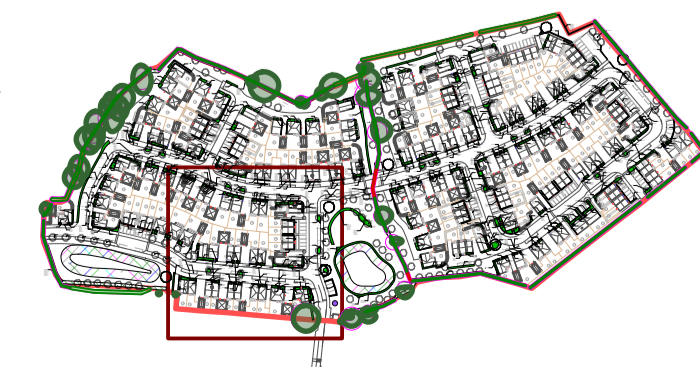

KEY:

Softworks

- Red line boundary
 - Shrub and perennial planting
 - Ornamental hedge planting
 - Ornamental gravel
 - Bulb planting in lawn
 - Bioretention matrix planting
 - Bioretention central shrubs
 - Native hedge planting
 - Emorsgate Seeds EL1 Flowering Lawn Mixture
 - Emorsgate Seeds EM2 Standard General Purpose Meadow Mixture
 - Shade-tolerant wildflower mix to not include any toxic species
 - Emorsgate Seeds EM8 Meadow Mixture for Wetlands for attenuation basin base.
 - Emorsgate Seeds EM4 Meadow Mixture for Clay Soils
 - Proposed tree
 - Proposed specimen tree
 - Retained existing tree canopy
 - Retained existing hedgerow
 - Removed vegetation
 - Root protection area
- Hardworks**
- Buff block paving (subject to Highways approval)
 - Grasscrete parking spaces
 - Hoggin path
 - LEAP surface to be specified by play designer
- Other hard surfaces to be determined by drainage requirements
- Street Furniture**
- Timber knee rail
 - Timber bench

NOTES:
NOT FOR SITE PURPOSES: This drawing is a general arrangement plan only and is not intended for site purposes.

SCALE: Do not scale from this drawing.
SETTING OUT: All setting out, levels, dimensions to be agreed on site. Do not use the information on this drawing without checking all dimensions on site. Any discrepancies between drawings, specifications and site works are to be reported to The Urbanists. Order of construction and setting out is to be agreed on site.

CHECK: This drawing must be the latest revision, read in conjunction with all other drawings, details, specifications and schedules. All dimensions are in millimetres unless otherwise stated. Where contradiction or uncertainty arises between the drawings and/or the schedule of works, it is the contractor's responsibility to seek verification from The Urbanists before proceeding. No claims will be met by The Urbanists, where the contractor continues work in absence of such confirmation.

No.	Date	By	Revision Notes
P01	06/04/21	GE	Graphical changes
P02	13/04/2021	GE	Plot, soft and hardworks changes

PROJECT STATUS: S3 (SUITABLE FOR REVIEW)

planning & design

Client: Barratt Homes

Project: Llewelyn Road, Penllergaer

Title: General Arrangement [8/8]

Project ID	Organiser	Volume	Level	Type	Role	Class	Dwg	Rev.	Status
1898	URB	XX	XX	DR	L	90	0208	P02	S3

Drawn: GE Date: 13/04/2021 Checked: GB Scale: 1:200@A1

The Urbanists - The Creative Quarter - BA Morgan Arcade - Cardiff - CF10 1AF
 T: 029 2023 6133 E: info@theurbanists.net W: www.theurbanists.net
 © This drawing is copyright and may not be reproduced in whole or part without written authority.

No-dig within root protection zone of Category A tree