



Bioretention Area Planting Notes
 These planting notes are guidelines for planning purposes only:

1.0 - General
 1.1 - All setting out shall be subject to the Landscape Architect (CA) on site.
 1.2 - All relevant, current British Standards will apply.
 1.3 - Planting will not be undertaken during waterlogged or frost bound conditions.

2.0 - Soils
 2.1 - Soil profile to be imported 300mm topsoil over 530mm loamy sand subsoil. Imported topsoil shall comply with BS3882:201 & imported subsoil shall comply with BS8601:2013 and shall be approved by the CA. Include slow release fertiliser at the time of planting - mix into top 200mm.
 2.2 - To ensure its free draining, mix topsoil with sand in the proportion of 1:1 (topsoil to sand)
 2.3 - Sand to be washed, lime-free with a minimum 90% of particles of sizes between 0.15 and 1.00mm, and less than 5% of particles <0.15mm and less than 5% of particles between 1.00 and 3.00mm.
 2.4 - Sub-soil underneath to be well broken up / intermixed or ripped at interface to ensure there is no sharp boundary.
 2.5 - If it is intended to import soil it is important that these have an interpretive report demonstrating fitness for purpose. Imported soils must not only meet BS, but have been found via a soil scientists interpretive report to be fit for the specific landscape function and contain no contaminants.
 2.6 - If it is intended to re-use site won soil then there must be a Soil Resource Survey and Plan - showing that a soil is fit for purpose in terms of human health, demonstrate fitness for plant health and contain no contaminants.

3.0 - Planting
 3.1 - All shrubs shall be planted within a minimum of 300mm topsoil.
 3.2 - A slow release fertiliser shall be applied to each bed at time of planting.
 3.3 - A 50mm layer of heavyweight mulch to act as top dressing.
 3.4 - Plant species to be as specified and approved by CA.
 3.5 - All plants shall conform to BS3936-1:1992 and planting operations shall be carried out in accordance with the relevant sections of BS4428:1989.
 3.6 - When planting daffodils and crocus, broadcast the bulbs by hand and plant where the bulbs fall to create natural swathes at the approximate density and within the areas indicated on the planting plans and plant schedule.
 3.7 - Berberis to be planted with the numbers shown down the centre of the indicated bioretention areas. The areas either side of the Berberis are a matrix of two Carex grasses, which should be spread throughout the beds, leaving pockets for the other perennials. Fritillaria bulbs to be spread across the beds in drifts.
 3.8 - For bioretention areas without Berberis planting (at the back of certain parking spaces), Deschampsia and Calamagrostis are to be dotted throughout the bed in groups of 3, with Carex divulsa spread between to create a foil for the other perennials. Fritillaria bulbs to be planted in drifts towards the edges of the beds.
 3.9 - For details of all other planting, see drawings 0301-0308.

4.0 - Maintenance
 4.1 - All planted areas shall be subject to a maintenance programme, which will include the replacement of failed plants at the time of practical completion and in each following year.
 4.2 - The programme of maintenance operations shall include the following:
 - Weeding and watering
 - Top dressing with fertiliser
 - Replacing/securing/tightening/loosening of tree stakes/ties as required.
 - Litter picking
 - Pruning of trees and hedging
 - Care of perennials and ornamental grasses

KEY:

- Red line boundary
- Bioretention matrix planting
- Bioretention central shrubs

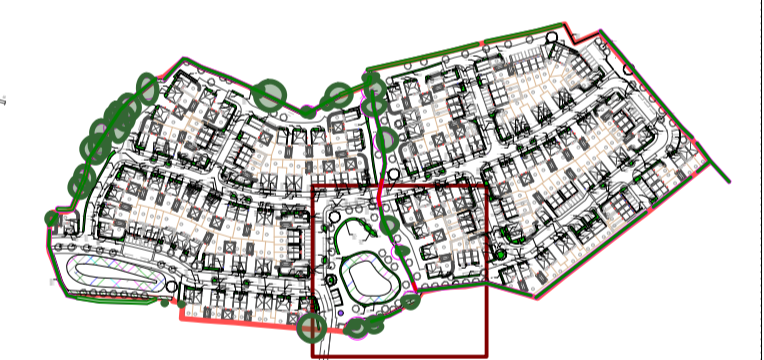

NOTES:
 NOT FOR SITE PURPOSES: This drawing is a general arrangement plan only and is not intended for site purposes.
 SCALE: Do not scale from this drawing.
 SETTING OUT: All setting out, levels, dimensions to be agreed on site. Do not use the information on this drawing without checking all dimensions on site. Any discrepancies between drawings, specifications and site works are to be reported to The Urbanists. Order of construction and setting out is to be agreed on site.
 CHECK: This drawing must be the latest revision, read in conjunction with all other drawings, details, specifications and schedules. All dimensions are in millimetres unless otherwise stated. Where and contradiction or uncertainty arises between the drawings and/or the schedule of works, it is the contractor's responsibility to seek verification from The Urbanists before proceeding. No claims will be met by The Urbanists, where the contractor continues work in absence of such confirmation.

No.	Date	By	Revision Notes
P01	13/04/2021	GE	Plot position changes

PROJECT STATUS:
 S3 (SUITABLE FOR REVIEW)

theurbanists
 planning & design

Client: Barratt Homes
 Project: Llewelyn Road, Penllergaer
 Title: Bioretention Planting [7/8]

Project ID	Organiser	Volume	Level	Type	Role	Class	Dwg	Rev.	Status
1898	URB	XX	XX	DR	L	90	0315	P01	S3

Drawn: GE Date: 13/04/2021 Checked: GB Scale: 1:200@A1

The Urbanists - The Creative Quarter - BA Morgan Arcade - Cardiff - CF10 1AF
 T: 029 2023 6133 E: info@theurbanists.net W: www.theurbanists.net
 © This drawing is copyright and may not be reproduced in whole or part without written authority.